

AFS101CS3DFi

IoT – ENABLED WC SENSOR FLUSH VALVE



Internet-of-Toilet (IoT) Features

- Fault detection with automated alert
- Self-diagnosis with recommended solutions
- Water consumption tracking
- Product activity monitoring to facilitate preventive maintenance services
- Monthly to yearly graphs and reports accessible via Rigel IoT dashboard

Product Features

- Accurate Sense+ 3.0 laser technology
- Touch-free flushing activation for optimum personal hygiene
- Color LED indication for different flushing stages
- Water saving dual flush operation
- Manual overriding button in case of power outage
- Anti-corrosion S/S grade 304 cover panel
- Easy installation and maintenance

Product Specification

- Installation type : Concealed box, front accessible maintenance service
- Dimension (front panel) : 204 x 204 mm
- Panel wall opening : 183 x 183 x 31 mm
- Material (front panel) : S/S 304
- Material (button) : S/S 304
- Material (flush valve) : Brass casting
- Power input : 220 – 240V AC 50/60Hz
- Sensing distance : 900mm
- Detection time : 6 seconds
- Manual override : Push button
- Operating water pressure : 1.5 – 3 bars (dynamic)
- Discharge volume : Nominal 3.5 Litres/ flush (full)
: <3.0 Litres/ flush (reduced)

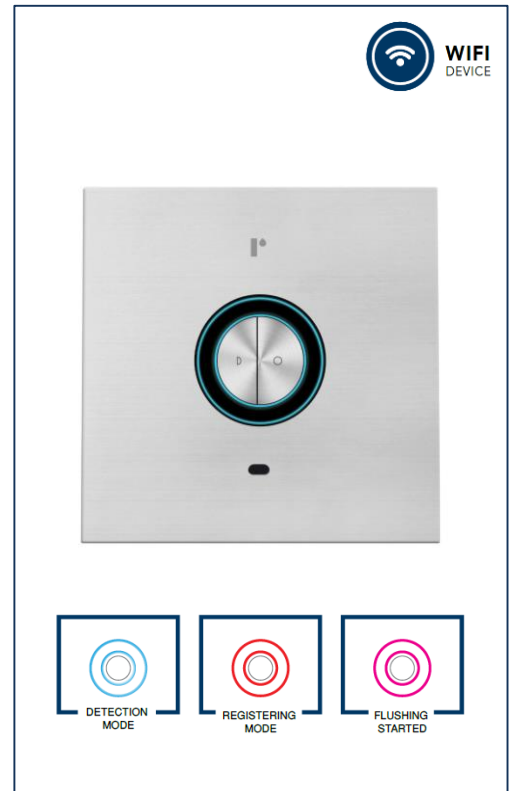

Rev	0.1
Date	24.02.2022

AFS101CS3DFi

IoT – ENABLED WC SENSOR FLUSH VALVE



Technical Drawing

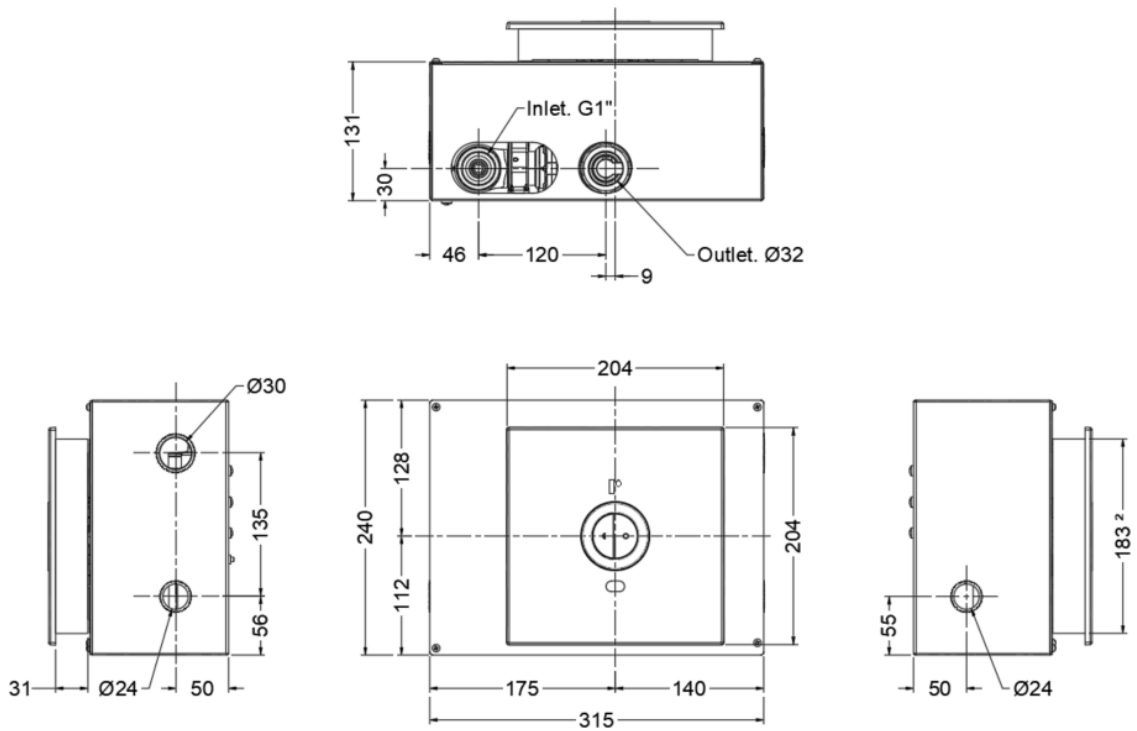

Copyright © RIGEL TECHNOLOGY (S) PTE LTD All rights reserved. Terms of Use.

AdvanceLiving

Rev	0.1
Date	24.02.2022

DISCLAIMER : While every effort has been made to ensure factual accuracy, the information presented is subject to changes due to requirements in different sites, markets and / or countries. Rigel reserves the right to make the necessary amendments at any time without prior notice.