

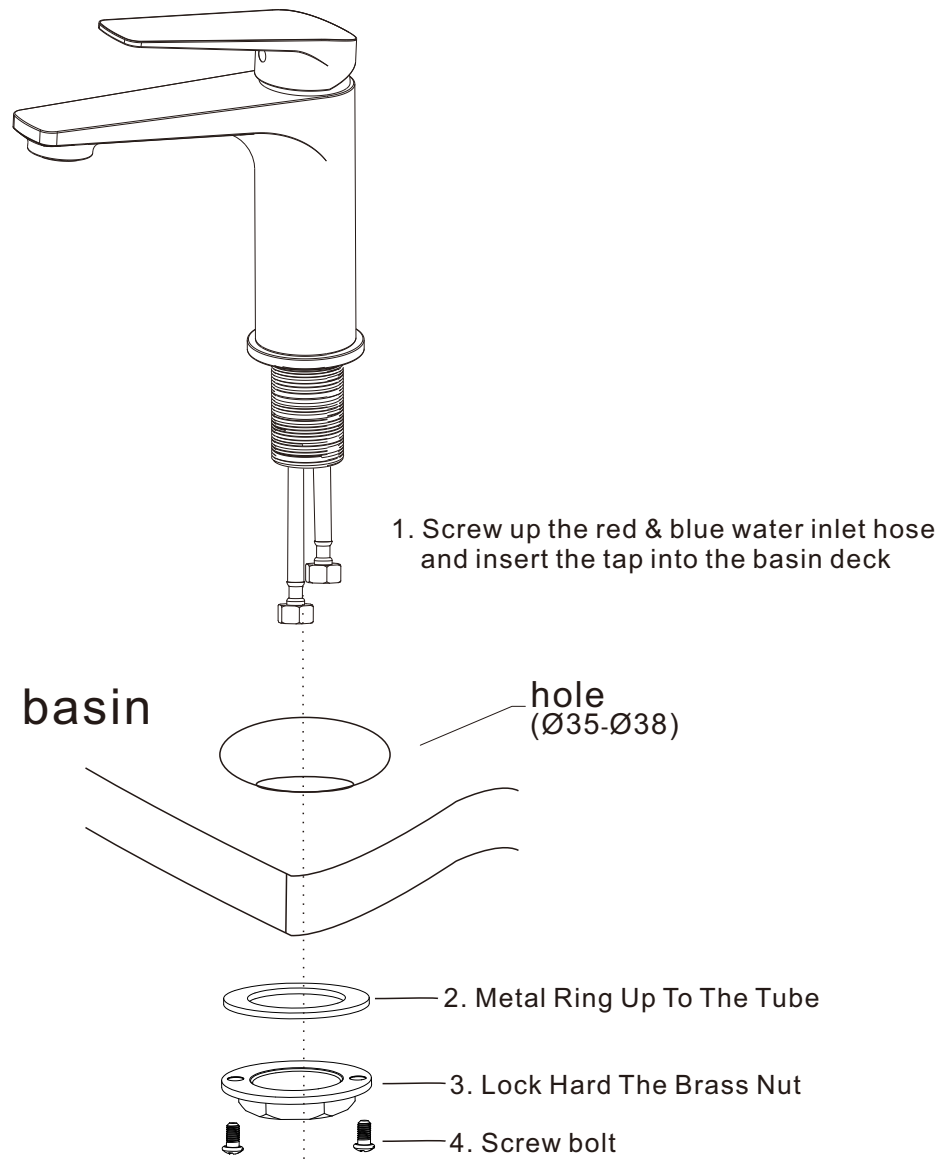

Model: R-MXB8701

Basin mixer



Before installing your new tap, flush through the pipework to ensure removal of debris, turn off the water supply.

Position the tap on the basin. From the underside of the basin fit the washer and nut. Tighten the nut to clamp the mixer to the basin.

CAUTION: Do not over tighten the nuts as this may damage the basin.

Connect the cold water and hot water supply to the inlet pipes with angle valve.